

Technical Description

The FEM series plug profile is produced according to ISO Standard 16028 and is compatible with other makes of the same standard. These couplings offer an absolutely dry break – no oil loss during uncoupling. Thanks to the valve design, the coupling has a minimum pressure drop, and thus achieves maximum cost-effectiveness.

Additional threads on request.

Advantages

The coupling can be operated with one hand and is equipped with a safety locking device to prevent unintentional uncoupling.

Working Temperature*

-30°C up to +100°C (NBR)
depending on the medium.

*At a temperature below -25°C and above +100°C alternative seals are available on request.

Working Pressure

See chart.

Nominal Diameter

1/4"	6,3 mm	= 31 mm ²
3/8"	10 mm	= 78 mm ²
1/2"	12,5 mm	= 122 mm ²
5/8"	16 mm	= 200 mm ²
3/4"	19 mm	= 280 mm ²
1"	25 mm	= 490 mm ²

Material Coupling

Coupling Body
Sleeve
Valve
Springs
Locking Balls
Seals
Valve Retainer
Thread Body

Standard

Steel, Zinc Pl., passivated, sealed
Steel, Zinc Pl., passivated, sealed
Steel, Zinc Pl., passivated, sealed
AISI 301
AISI 420 C
NBR
Steel, Zinc Pl., passivated
Steel, Zinc Pl., passivated, sealed

Plug

Plug Body
Valve
Springs
Seals
Valve Retainer
Thread Body

Steel, Hardened, Zinc Pl., passivated, sealed
Steel, Zinc Pl., passivated, sealed
AISI 301
NBR/PUR
Brass
Steel, Zinc Pl., passivated, sealed

Pressure Drop

Flow Capacity Viscosity for 32cSt at 40°C as per ISO 7241/2-2000

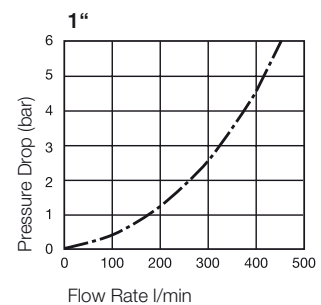
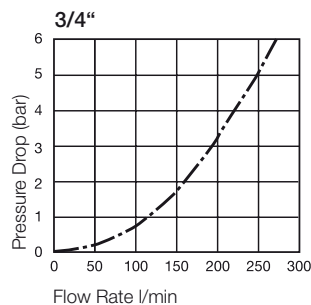
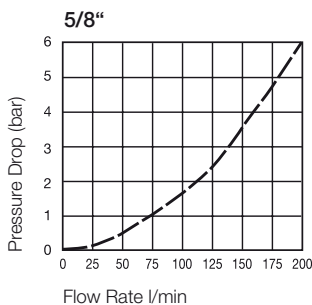
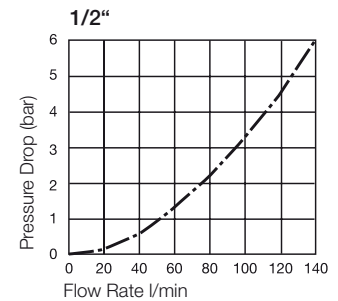
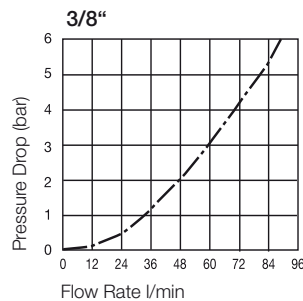
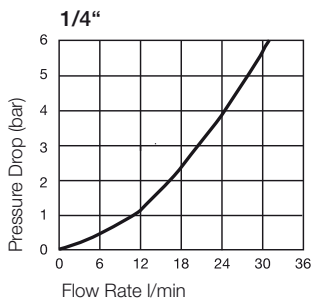

Couplings

FEM Series

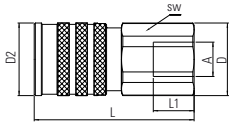

Female Thread

Body Size Inch	Connection A	Hex SW	Hex SW1	L mm	L1 mm	D mm	D2 mm	Working Press. in bar	Version	Seal	Part Number
1/4"	G 1/4	27		64	12	29,5	29	315	Standard	NBR	FEM-251-4FB
3/8"	G 3/8	30		71	12	32	32	250	Standard	NBR	FEM-371-6FB
3/8"	G 1/2	30		73	14	32	32	250	Standard	NBR	FEM-371-8FB
3/8"	7/8-14 UNF	30		76	14	32	32	250	Standard	NBR	FEM-371-10FO
1/2"	G 1/2	36		76	14	40	39	250	Standard	NBR	FEM-501-8FB
1/2"	G 3/4	36		80	16	40	39	250	Standard	NBR	FEM-501-12FB
5/8"	G 3/4	40		82	16	43	42	250	Standard	NBR	FEM-621-12FB
3/4"	G 1	46		102	18	50	46	250	Standard	NBR	FEM-751-16FB
1"	G 1 1/4	55		106	19	60	55	200	Standard	NBR	FEM-1001-20FB

Plugs

FEM Series

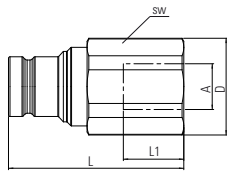

Female Thread

Body Size Inch	Connection A	Hex SW	Hex SW1	L mm	L1 mm	D mm	D1 mm	D2 mm	Working Press. in bar	Version	Seal	Part Number
1/4"	G 1/4	22		49	12	24,5			315	Standard	NBR	FEM-252-4FB
3/8"	G 3/8	30		58	12	32			250	Standard	NBR	FEM-372-6FB
3/8"	G 1/2	30		60	12	32			250	Standard	NBR	FEM-372-8FB
3/8"	7/8-14 UNF	30		63	12	32			250	Standard	NBR	FEM-372-10FO
1/2"	G 1/2	36		66	14	40			250	Standard	NBR	FEM-502-8FB
1/2"	G 3/4	36		70	16	40			250	Standard	NBR	FEM-502-12FB
5/8"	G 3/4	36		71	16	40			250	Standard	NBR	FEM-622-12FB
3/4"	G 1	46		83	18	50			250	Standard	NBR	FEM-752-16FB
1"	G 1 1/4	55		90	19	60			200	Standard	NBR	FEM-1002-20FB

Dust Protection

FEM Series

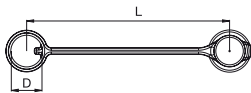

Body Size Inch	Description	L mm	D mm	Material	Color	Part Number
1/4"	Coupling	160	24	PVC	Blue	PFE-251-P
1/4"	Plug	160	23	PVC	Blue	CFE-252-P
3/8"	Coupling	170	28	PVC	Blue	PFE-371-P
3/8"	Plug	170	28	PVC	Blue	CFE-372-P
1/2"	Coupling	185	35	PVC	Blue	PFE-501-P
1/2"	Plug	185	35	PVC	Blue	CFE-502-P
5/8"	Coupling	215	37	PVC	Blue	PFE-621-P
5/8"	Plug	215	37	PVC	Blue	CFE-622-P
3/4"	Coupling	185	42	PVC	Blue	PFE-751-P
3/4"	Plug	185	42	PVC	Blue	CFE-752-P
1"	Coupling	240	50	PVC	Blue	PFE-1001-P
1"	Plug	240	50	PVC	Blue	CFE-1002-P